

**Limestone or Natural Stone, Xci Foil (Class A)  
and Xci 286, Concrete**

View WRB placement variations p.2

**WrapShield SA Self-Adhered** is a self-adhered, water resistive (WRB) vapor permeable air barrier sheet membrane adhered directly to substrate.

**RevealShield SA Self-Adhered** is a black, UV stable, water resistive (WRB) vapor permeable self-adhered air barrier membrane for open joint rain screen cladding systems.

Per Chapter 26 of the International Building Code, the wall assembly shall be tested in accordance with and comply with the acceptance criteria of NFPA 285. The listed assemblies in this document have met that criteria according to Hunter Panels. Visit [hunterpanels.com](http://hunterpanels.com) for verification.

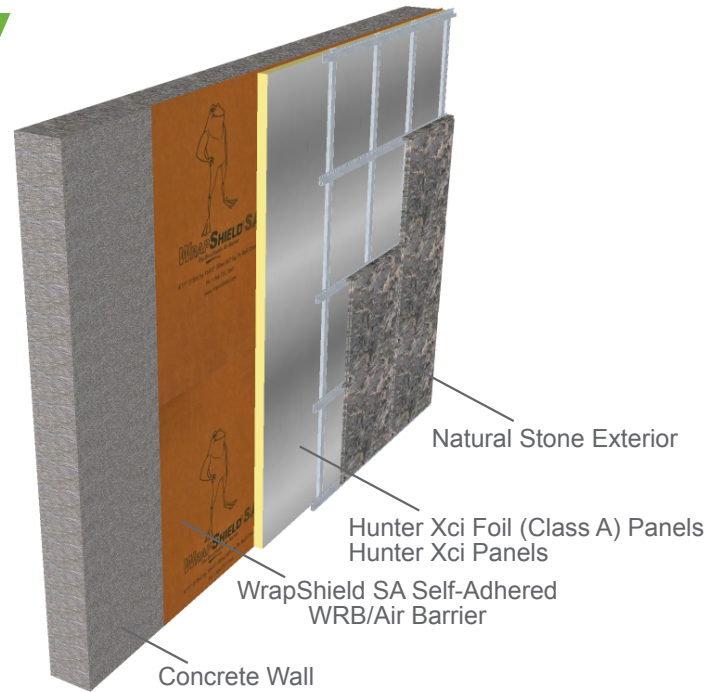

Comprehensive details available at [VaproShield.com](http://VaproShield.com).  
Illustration for explanatory purposes only.

**Wall Component**

**Materials**

**Base Wall System**

Concrete Wall (cast in place or precast)

**Approved Exterior Finish**

**Limestone or Natural Stone**—Minimum 1.25" thick, Limestone or Natural Stone Veneer. Any Standard installation technique can be used

**Stone Aluminum**—Stone Aluminum Honeycomb Composite Panels that have been successfully tested by the panel manufacturer via the NFPA 285 test method. Any standard installation technique can be used.

**Material Options**

- 1) 4.2" max thickness of **Hunter Xci Ply**, inclusive of factory adhered 5/8" or 3/4" Fire Treated Plywood or **FSC®** Certified Fire Treated Plywood within overall max thickness
- 2) 4.7" max thickness of **Hunter Xci Ply**, inclusive of factory adhered 5/8" or 3/4" Fire Treated Plywood or **FSC®** Certified Fire Treated Plywood within overall max thickness with non-combustible claddings

**Floorline Firestopping**

Not Applicable

**Stud Cavity**

Not Applicable

**Exterior Sheathing**

Not Applicable

**Weather Resistive Membrane Applied to Base Wall**

VaproShield WrapShield SA Self-Adhered, RevealShield SA Self-Adhered

**Weather Resistive Membrane Applied to Exterior Insulation**

VaproShield WrapShield SA Self-Adhered, RevealShield SA Self-Adhered

The location and number of WRB's in the wall assembly are determined by the architect.  
See p.2 for additional illustrations showing VaproShield WRB/Air Barrier placement.

## VaproShield WRB/Air Barrier Placement Variations

as per Hunter NFPA 285 Test Data

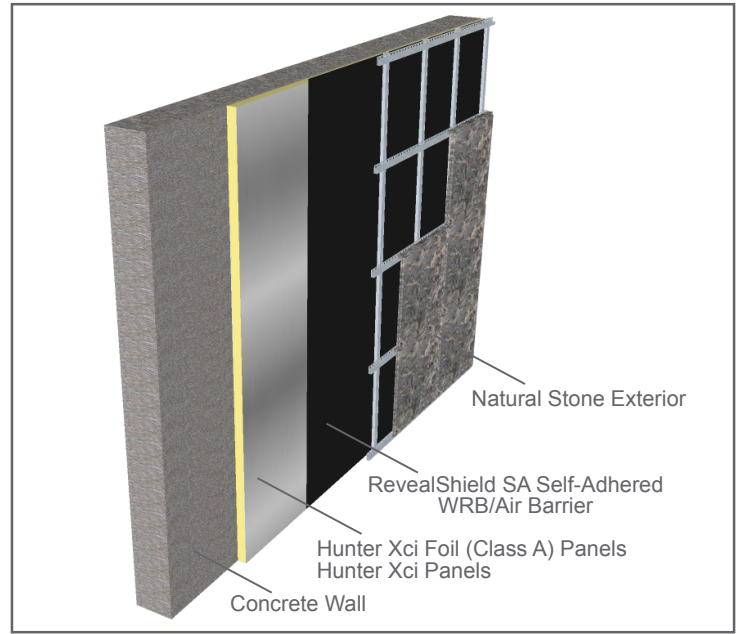
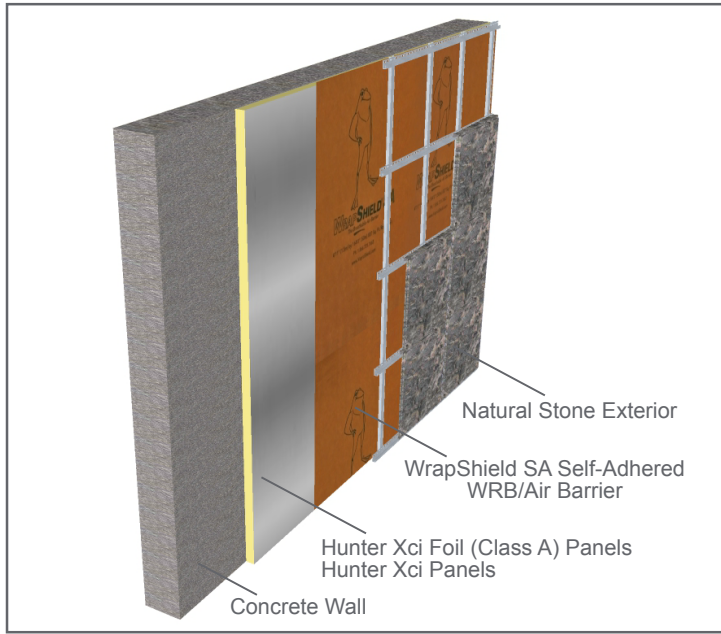

Comprehensive details available at [VaproShield.com](http://VaproShield.com).  
Illustration for explanatory purposes only.