

# Base of Wall Detail

Polyguard Detail Sealant PW or Polyguard LM95 applied to the top of the termination bar and covering a minimum 1/8" beyond perimeter of fastener head

PanelShield SA Air barrier WRB membrane\*

Polyguard 12" Detail Tape, Detail Tape WRM or a 12" strip of Polyguard membrane: 650 or 650 WRM applied and centered (6" on each concrete face)

3/4" fillet of Polyguard Detail Sealant PW or Polyguard LM-95 applied to raw concrete

Polyguard Membrane: 650, 650 PRM or 650 WRM applied to horizontal substrate prepared with Polyguard 650 LT Liquid Adhesive or Polyguard California Sealant at a rate of 250 - 300 sf/gal or Polyguard 650 WB Liquid Adhesive at a rate of 350 - 400 sf/gal - terminating at the fillet - slope to drain

Polyguard Polyflow 18 or Polyflow 15 / 15P sheet molded drain or protection - woven mesh facing topping slab

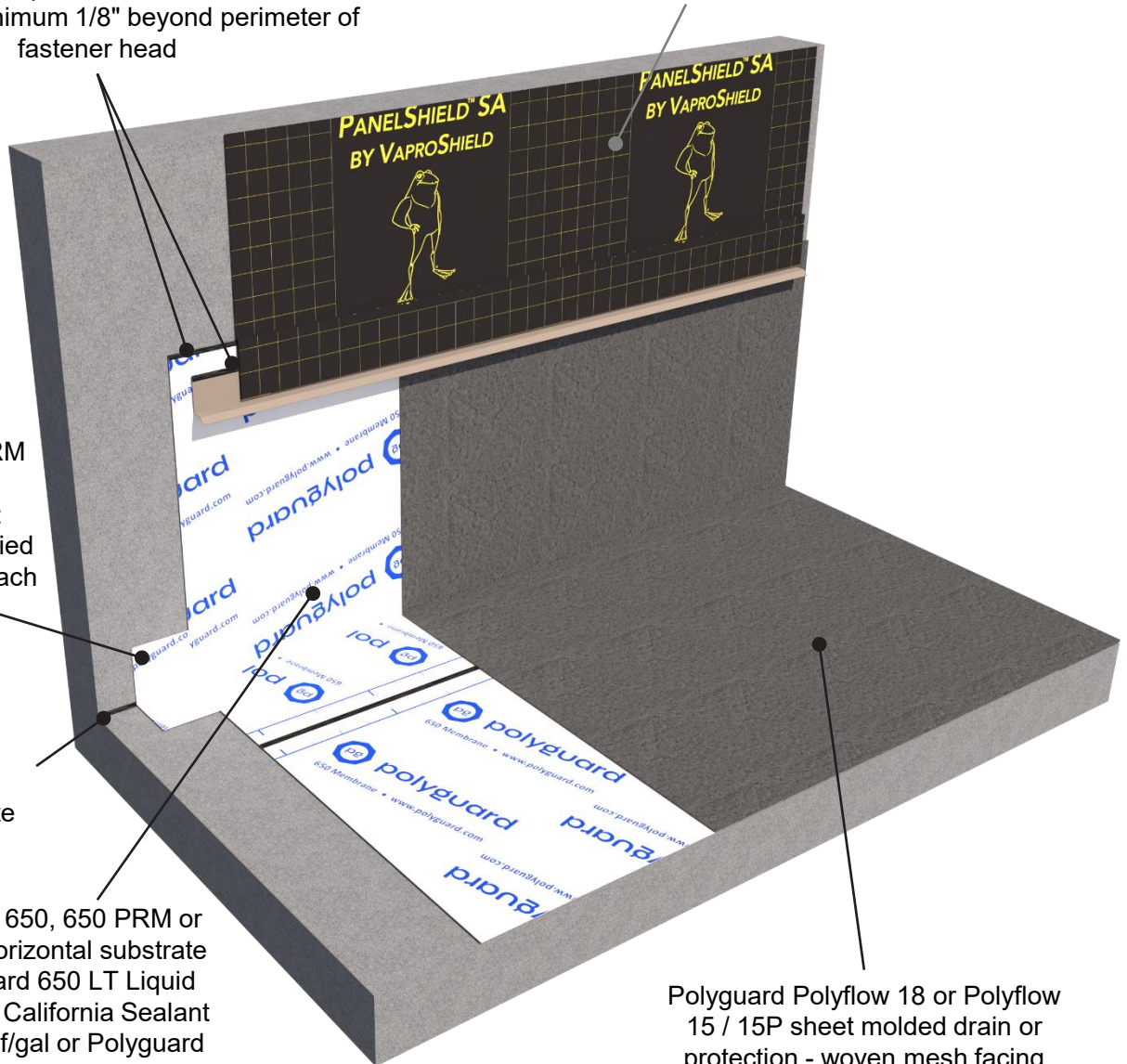

**VAPROSHIELD**  
Breathable Membrane Systems for Roofs & Walls

**polyguard**

## PRODUCT DESCRIPTION

\*This detail is compatible with all VaproShield self-adhered WRB/AB sheet membranes. The appropriate VaproShield WRB/AB product shall be selected based on project-specific requirements.

## DISCLAIMER

Detail sketch is generic, representing suggested best practices for VaproShield materials, and does not represent a specific job site condition and therefore may not be applicable to certain projects. Detail sketch is designed for use as a reference and must be approved by the designer/consultant of record for each project prior to installation by the subcontractor. Changes and approvals of VaproShield details are the sole responsibility of the designer/consultant of record. VaproShield is **not** the designer of record for building enclosure details and takes no responsibility for the accuracy or interpretation of actual project site conditions.

DRAWN BY: AR

DATE: 4/5/26

REF: 361